

INSTRUCTION MANUAL

LED mirror

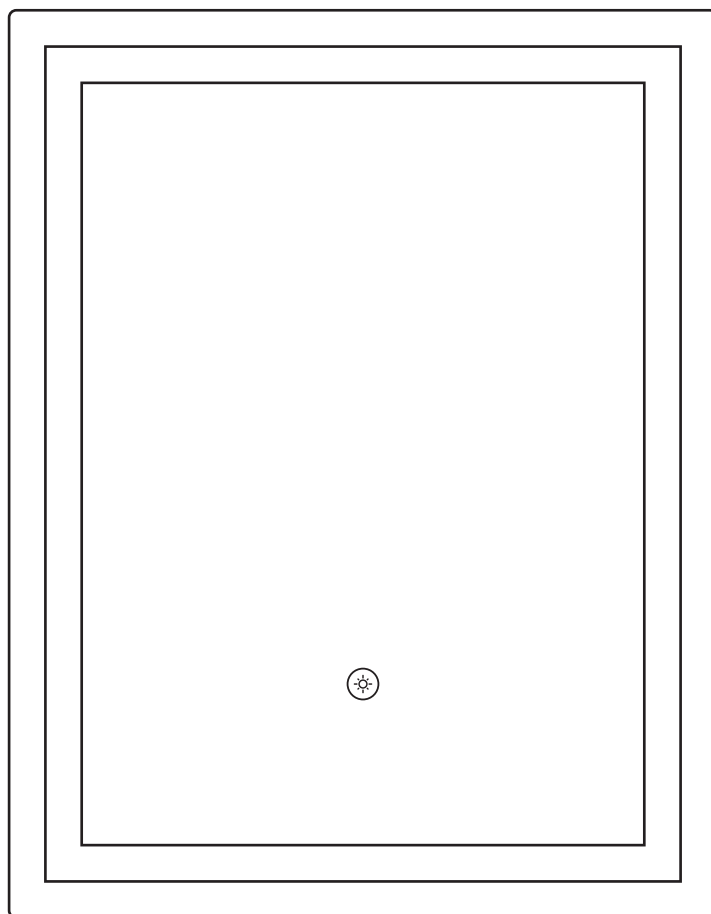

SKU:2MIR145

Hanging the mirror

Installation Procedure

Notes: To ensure the normal use of products, it is required you set out wires as per the regulations of IEE at the installation places. The Products are only applicable to being installed on the indoor solid wall. The installation must be carried out by a professional electrician and wrong installation may lead to product damage and personal injury.

Installation Tools

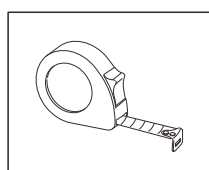

Measuring tape

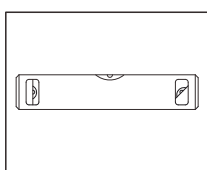

Spirit level

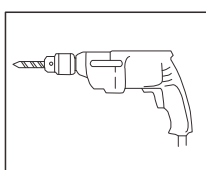

Drill

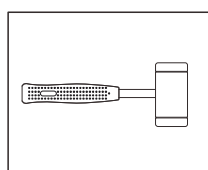

Hammer

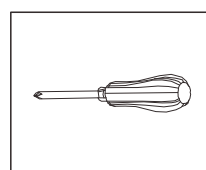

Screwdriver

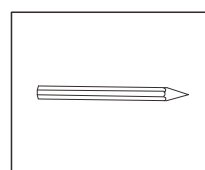

Pencil

Installation Steps

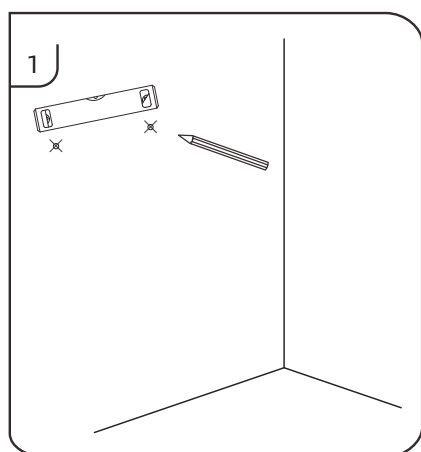

Make sure the wall is solid and suitable for safely supporting the overall weight of the mirror once installed. Use a pencil to measure and mark the positions of the mirror nails, securing screws, and Rawl plugs. At the same time, use a spirit level to ensure the bracket is perfectly level.

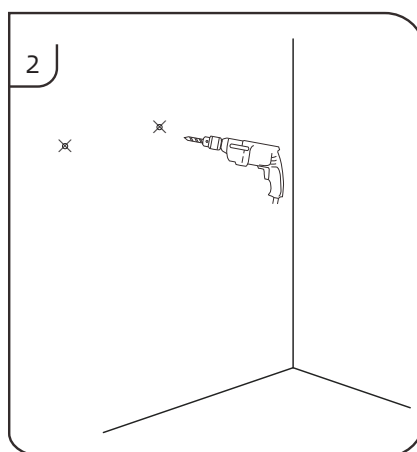

Select a $\phi 6$ drill bit and drill holes in the marked area to a depth of 40mm. (If the wall is tile, use a special ceramic drill).

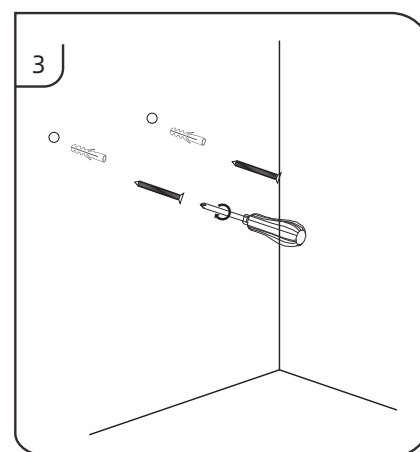

Insert Rawl plugs into drilled holes, and then screw the hook into the hole.

Hanging the mirror

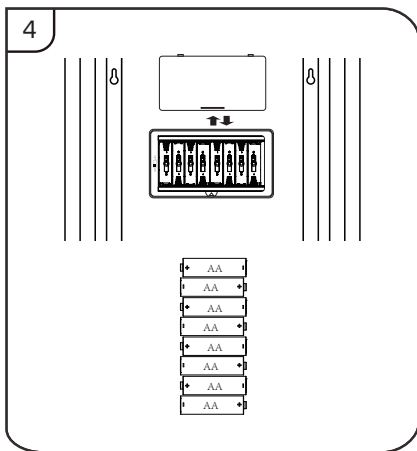

Open the battery box cover in the middle of the backplane, place eight AA batteries, cover the battery box, and turn ON the battery switch.

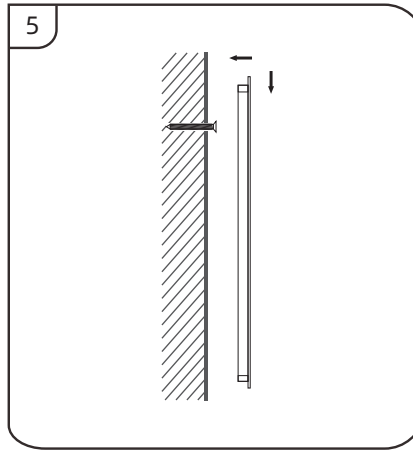

Hang the product on the wall hook.

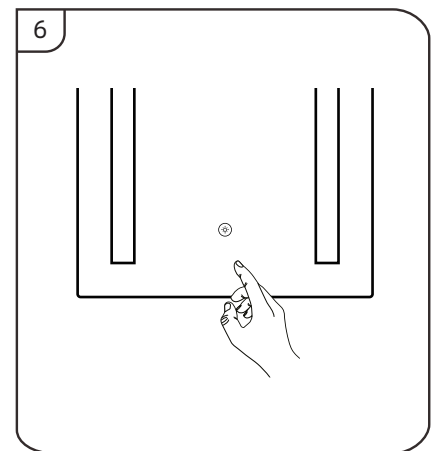

Finally, just touch the button to turn the mirror and turn the light on and off.

Wiring Diagram for Input

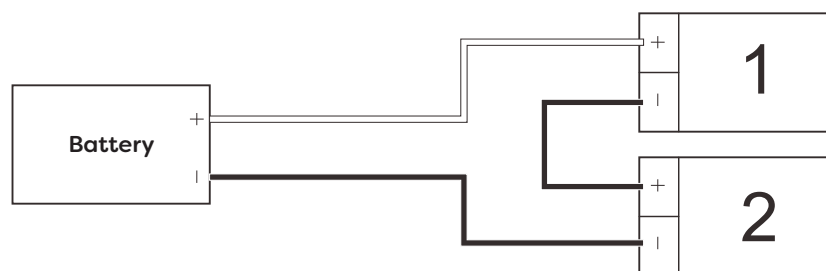

1 Rocker switch

2 LED Supply

Recycling and disposal

Please recycle the packaging in accordance with your local government regulations on waste handling, and follow the same advice at the end of the products life.