

# INSTRUCTION MANUAL

## LED mirror

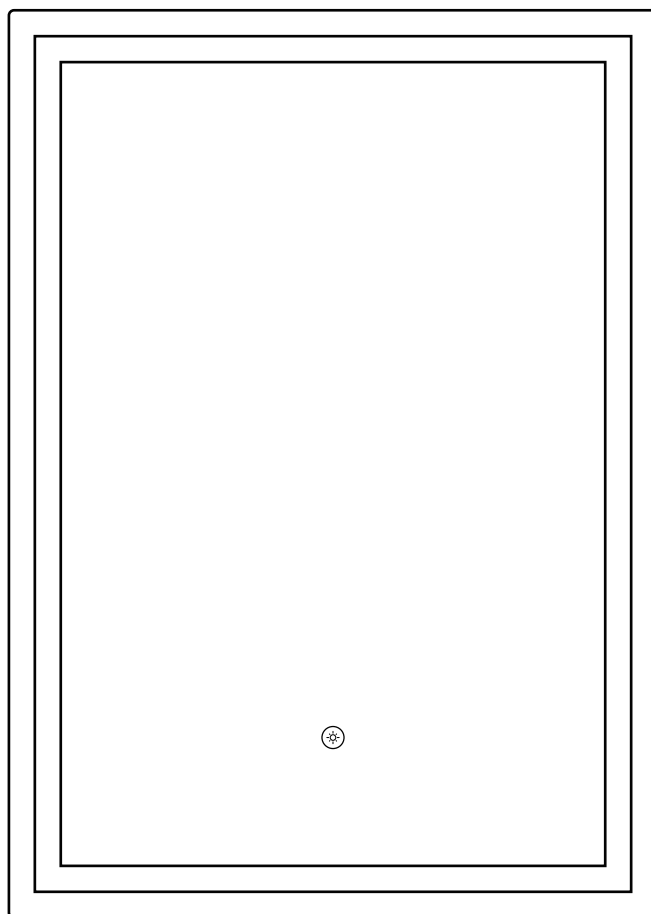

**SKU:**2MIR144/2MIR124/2MIR125

# Hanging the mirror

## Installation Procedure

---

Notes: To ensure the normal use of products, it is required you set out wires as per the regulations of IEE at the installation places. The Products are only applicable to being installed on the indoor solid wall. The installation must be carried out by a professional electrician and wrong installation may lead to product damage and personal injury.

## Installation Tools

---

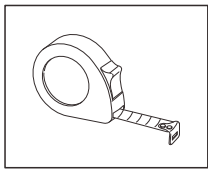

Measuring tape

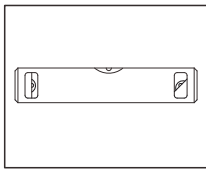

Spirit level

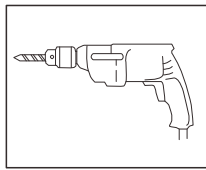

Drill

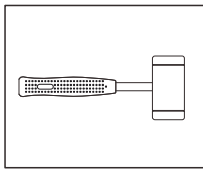

Hammer

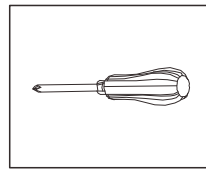

Screwdriver

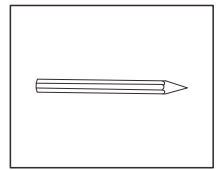

Pencil

## Installation Steps

---

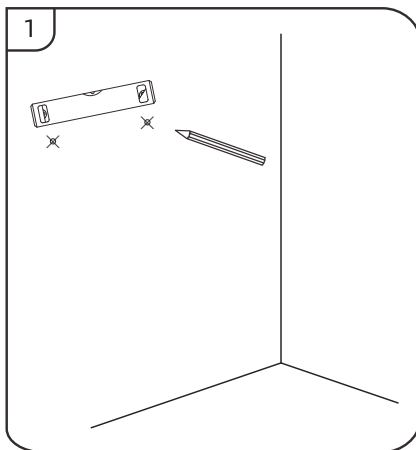

Make sure the wall is solid and suitable for safely supporting the overall weight of the mirror once installed. Use a pencil to measure and mark the positions of the mirror nails, securing screws, and Rawl plugs. At the same time, use a spirit level to ensure the bracket is perfectly level.

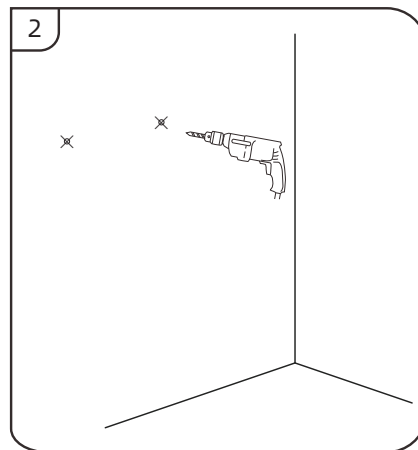

Select a  $\phi 6$  drill bit and drill holes in the marked area to a depth of 40mm. (If the wall is tile, use a special ceramic drill).

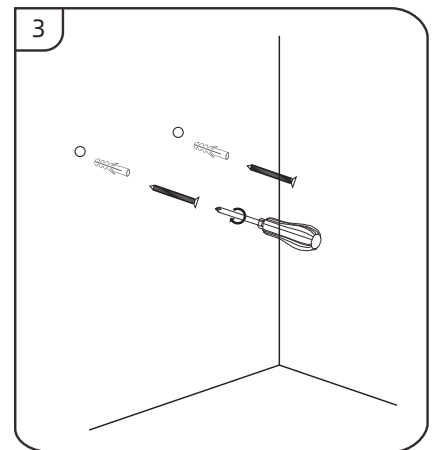

Insert Rawl plugs into drilled holes, and then screw the hook into the hole.

# Hanging the mirror

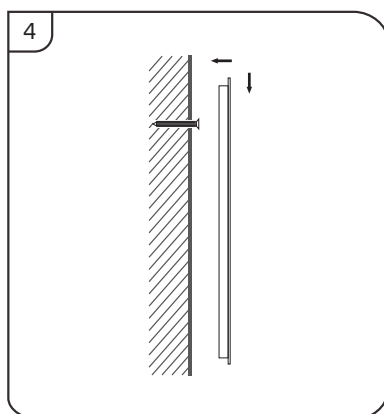

Hang the product on the wall hook.

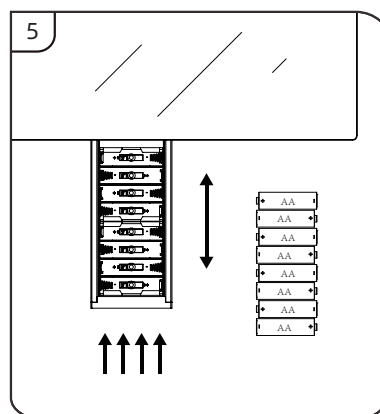

Press the battery box at the bottom of the mirror, the battery box pops out, put 8 AA batteries, push the battery box into the fixed position to close.

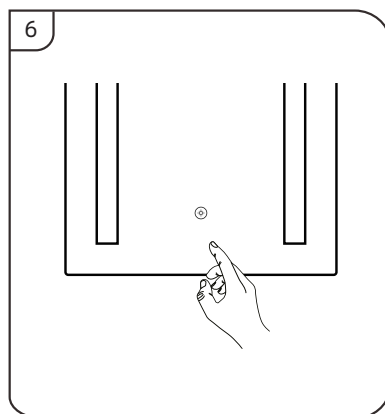

Finally, just touch the button to turn the mirror and turn the light on and off.

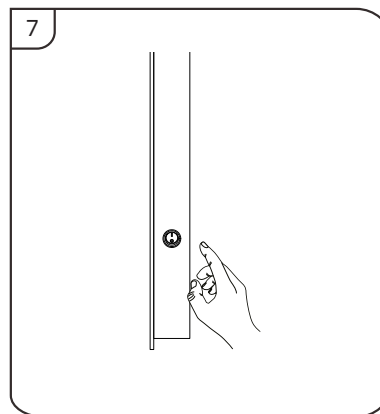

Finally, simply press the button to turn the light on or off.

## Wiring Diagram for Input

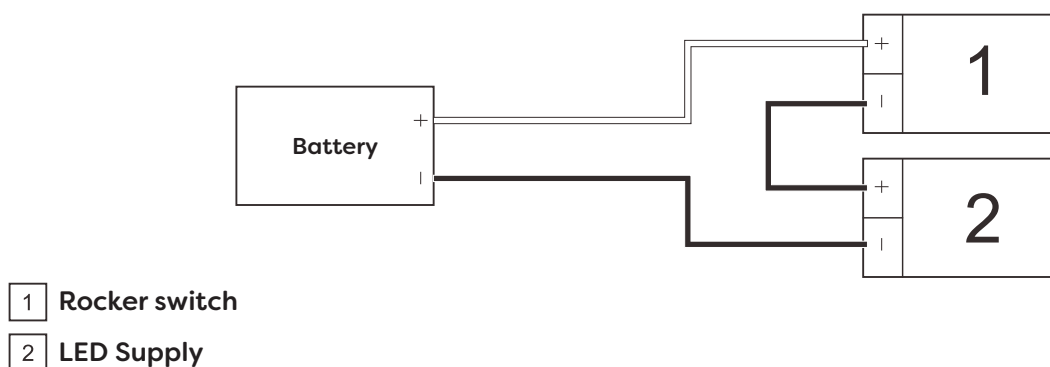

## Recycling and disposal

Please recycle the packaging in accordance with your local government regulations on waste handling, and follow the same advice at the end of the products life.

# Battery Mirror Instructions

## Special Notice

Only need to unscrew this one screw with a screwdriver.

Remove the screw, then slide open the battery box and insert the batteries.

