

Caspian Universal Concealed

The Caspian Concealed fan convector was developed for recessed or concealed heating projects. This is another versatile heating solution from Smith's, suitable for high, low or ceiling concealed installations and the UVC can even be turned upside down.

Compatible with all types of wet central heating systems and any commercial or domestic air source heat pump project, the Caspian Concealed has four different main accessories. They function together in any combination to create the recessed or concealed heating solution required, depending on the project specification.

The four main accessories (see page 9) comprise: two different spigot inlet/outlets, one with two ducts to suit the UVC90 and the other with three ducts to suit the UVC120; the cranked duct, angled at 90° for left or right-handed use; a 1m adjustable straight air inlet/outlet extension duct, which can be used alone or with additional lengths; and an air inlet/outlet grille.

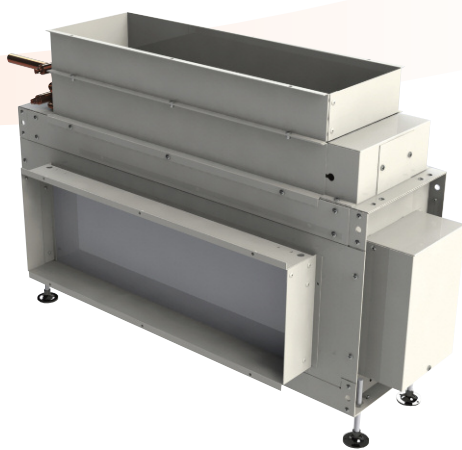

Model	Heat Output at 80°			Heat Output at 75°			Heat Output at 70°		
	Low (KW/BTU)	Medium (KW/BTU)	High (KW/BTU)	Low (KW/BTU)	Medium (KW/BTU)	High (KW/BTU)	Low (KW/BTU)	Medium (KW/BTU)	High (KW/BTU)
Caspian UVC 120	6.7 (22700)	10.6 (36000)	14.5 (49400)	6.1 (20937)	9.6 (32968)	13.2 (45000)	5.6 (19100)	8.7 (29800)	11.8 (40400)
Caspian UVC 90	5.2 (17700)	7.8 (26500)	10.3 (35200)	4.8 (16300)	7.2 (24600)	9.6 (32800)	4.4 (15000)	6.7 (22700)	8.9 (30400)

Model	Heat Output at 65°			Heat Output at 60°			Heat Output at 55°		
	Low (KW/BTU)	Medium (KW/BTU)	High (KW/BTU)	Low (KW/BTU)	Medium (KW/BTU)	High (KW/BTU)	Low (KW/BTU)	Medium (KW/BTU)	High (KW/BTU)
Caspian UVC 120	4.9 (16600)	7.7 (26400)	10.6 (36200)	4.1 (14100)	6.7 (23000)	9.4 (32000)	3.4 (11600)	5.8 (19700)	8.1 (27700)
Caspian UVC 90	3.9 (13500)	6.0 (20400)	8.0 (27300)	3.5 (11900)	5.3 (18000)	7.1 (24200)	3.0 (10400)	4.6 (15800)	6.2 (21100)

Model	Heat Output at 50°			Heat Output at 45°			Heat Output at 40°		
	Low (KW/BTU)	Medium (KW/BTU)	High (KW/BTU)	Low (KW/BTU)	Medium (KW/BTU)	High (KW/BTU)	Low (KW/BTU)	Medium (KW/BTU)	High (KW/BTU)
Caspian UVC 120	2.7 (9000)	4.8 (16300)	6.9 (23500)	2.0 (6700)	3.7 (12600)	5.4 (18400)	1.3 (4400)	2.6 (8900)	3.9 (13400)
Caspian UVC 90	2.6 (8800)	3.9 (13400)	5.3 (18000)	2.0 (7000)	3.1 (10500)	4.1 (14000)	1.5 (5100)	2.2 (7500)	2.9 (10000)

Heat outputs tested in accordance with BS4856 using mean water temperature, 18°C entering air temperature, 10°C temperature drop and a flow rate of 340 litres/h.

Model							Total Power Consumption			
	Flow & Return Connections	Mains Cable	Transformer	Flexible Hoses	Isolation Valves	Fused Spur	Low (Watts)	Medium (Watts)	High (Watts)	Water Capacity (Litres)
Caspian UVC 120	22mm	n/a	n/a	n/a	n/a	3A	13	62	110	2.08
Caspian UVC 90	22mm	n/a	n/a	n/a	n/a	3A	15	43	70	1.50

Model	Sound Levels				
	High (dBA)	Medium (dBA)	Low (dBA)	Casting Colour	Fan Only
Caspian UVC 120	58	46	35	n/a	n/a
Caspian UVC 90	53	42	34	n/a	n/a

Measured at 3m in front of floor mounted model.

Correction factors

Mean Water Temperature °C	
EAT°C	80 to 40
15	1.10
21	0.93

Temperature Drop °C				
	20	15	10	5
Factor	0.89	0.95	1.00	1.04

Principal Accessories

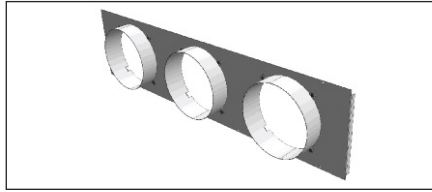

Circular spigot (200mm x 3) air inlet/outlet duct (to suit UVC120)



90°C cranked air inlet/outlet duct (to suit UVC90 & UVC120)



Anodised aluminium inlet/outlet grille (to suit UVC90 & UVC120)

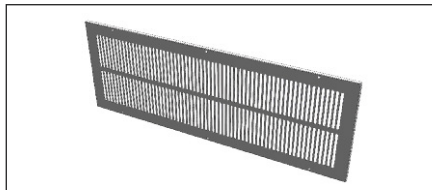

Powder-coated steel inlet/outlet grille (to suit UVC90 & UVC120)



Adjustable low temperature cut-out

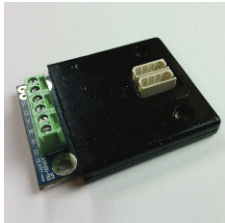

Proportional heat output controller

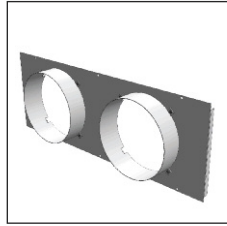

Circular spigot (200mm x 2) air inlet/outlet duct (to suit UVC90)

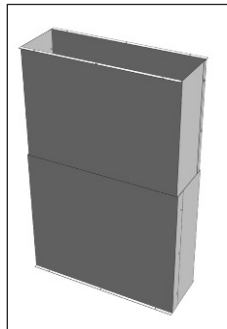

1m adjustable straight air inlet/outlet extension duct (to suit UVC90 & UVC120)



External control harness



22mm flexible hoses

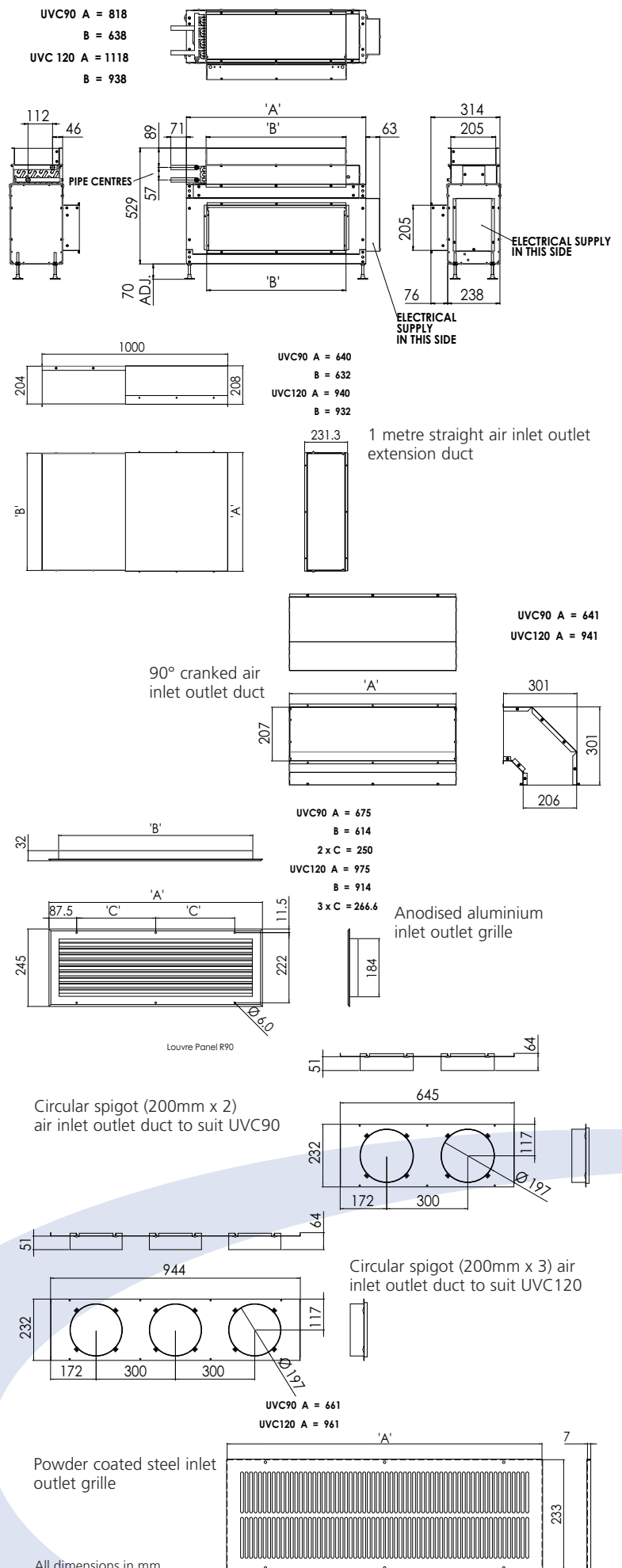

Caspian Universal Concealed

Finish

Casing: galvanised steel 1.2mm

Installation

- Suitable for two-pipe central heating systems
- Unit must be earthed

Commissioning

Check water is hot enough to activate the low temperature cut-out thermostat

Controls

Variable heat output controller (mounted within the product)

Accessories

- Adjustable low temperature cut-out
- External control harness (for up to four products)
- Proportional heat output controller
- 22mm flexible hoses (pair)
- White powder-coated steel inlet/outlet grille (to suit UVC90 & UVC120)
- Anodised aluminium air inlet/outlet grille (to suit UVC90 & UVC120)
- 90°C cranked air inlet/outlet duct (to suit UVC90 & UVC120)
- 1m adjustable straight air inlet/outlet extension duct (to suit UVC90 & UVC120)
- Circular spigot (200mm x 2) air inlet/outlet duct (to suit UVC90)
- Circular spigot (200mm x 3) air inlet/outlet duct (to suit UVC120)

Caspian Universal Concealed

Floor mounted application

The Caspian Universal Concealed can be installed either on or behind walls at high and low level, in ceiling voids and on or under floors. Detailed below are a number of application options than can be achieved with the Caspian Universal Concealed and Accessories. If in doubt please contact us.

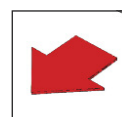

Air outlet

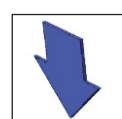

Air inlet option



Reversible

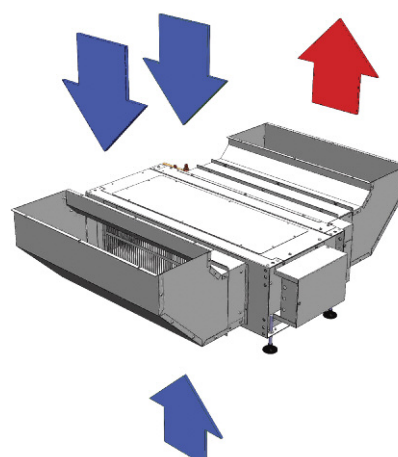
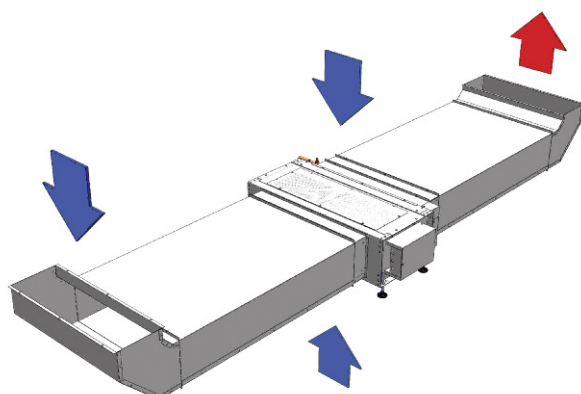
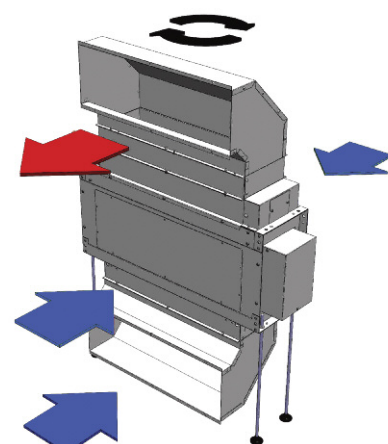
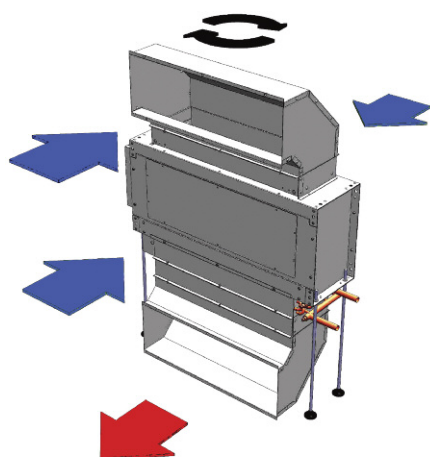
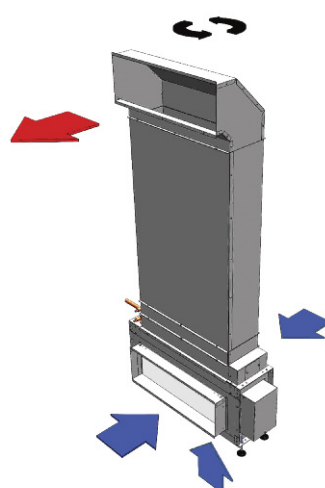
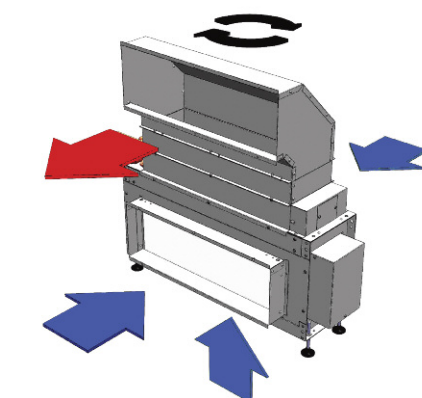
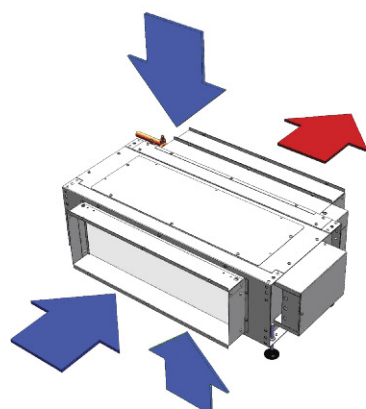
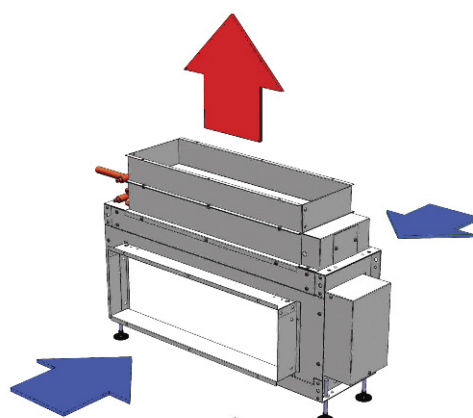

Suspended with ducts application

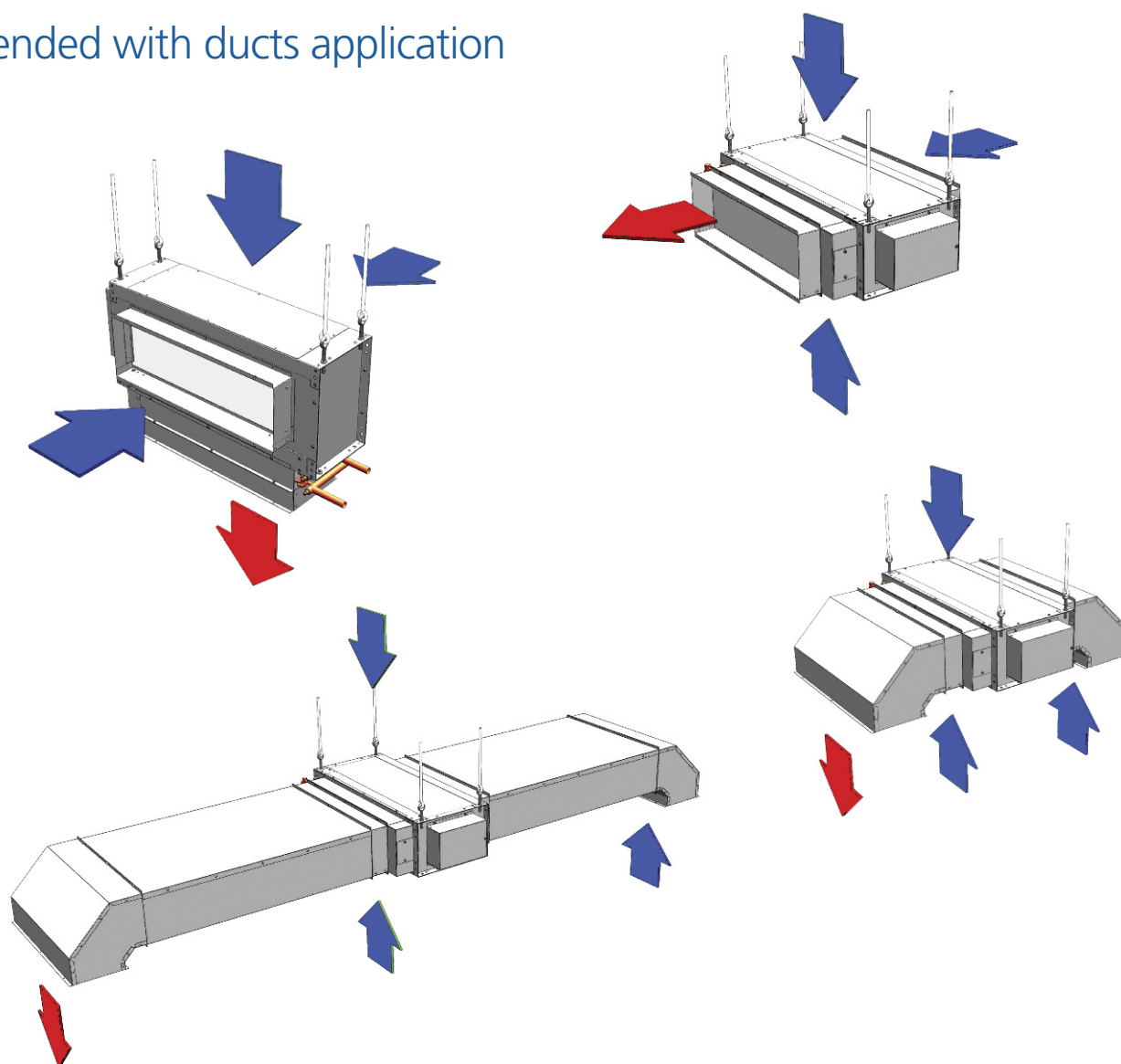

Suspended with spigots application

