

Geberit Mapress Copper bend (gas)

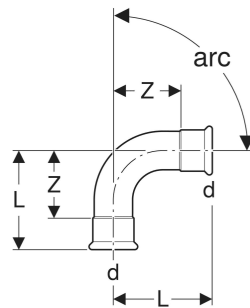

Example image



APPLICATION PURPOSES

- For natural gases
- For liquefied gases
- For natural and liquefied gases

CHARACTERISTICS

- Pressing indicator
- Leaky if unpressed
- Marked in yellow
- Seal ring made of HNBR, yellow

- Pressing socket with yellow protection plug

TECHNICAL DATA

Product material Cu-DHP copper CW024A (EN 1412)

Art. no.	DN	d, ø mm	arc °	L cm	Z cm
34514	12	15	45	2.8	0.8
34515	15	18	45	2.9	0.9
34516	20	22	45	3.2	1.1
34517	25	28	45	3.7	1.4
34518	32	35	45	4	1.4

<i>Art. no.</i>	<i>DN</i>	<i>d, ø mm</i>	<i>arc °</i>	<i>L cm</i>	<i>Z cm</i>
34519	40	42	45	4.7	1.7
34520	50	54	45	5.7	2.2
34500	12	15	90	3.8	1.8
34501	15	18	90	4.2	2.2
34502	20	22	90	4.7	2.6
34503	25	28	90	5.7	3.4
34504	32	35	90	6.5	3.9
34505	40	42	90	7.6	4.6
34506	50	54	90	9.5	6