

# Geberit Mapress Copper bend

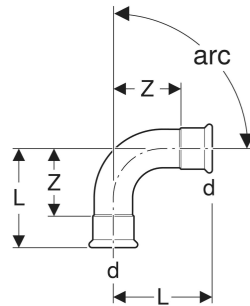

Example image



## APPLICATION PURPOSES

- For cold and hot potable water
- For cooling and heating water without antifreeze agent
- For cooling and heating water with antifreeze agent
- For district heating water  $\leq 120$  °C
- For service water and process water
- For compressed air (oil purity class 0–3)

- For negative pressure
- For inert gases (e.g. nitrogen)
- For technical building systems, industry and shipbuilding

- Seal ring made of CIIR, black, up to  $\varnothing \leq 54$  mm
- Seal ring made of EPDM, black, from  $\varnothing > 54$  mm
- Pressing socket with transparent protection plug

## CHARACTERISTICS

- Pressing indicator
- Leaky if unpressed up to  $\varnothing \leq 54$  mm

## TECHNICAL DATA

Product material Cu-DHP copper CW024A (EN 1412)

Art. no.	DN	d, $\varnothing$ mm	arc °	L cm	Z cm
60601	10	12	45	2.6	0.9
60602	12	15	45	2.8	0.8
60603	15	18	45	2.9	0.9
60604	20	22	45	3.2	1.1
60605	25	28	45	3.7	1.4

<i>Art. no.</i>	<i>DN</i>	<i>d<sub>e</sub> mm</i>	<i>arc °</i>	<i>L cm</i>	<i>Z cm</i>
60606	32	35	45	4	1.4
60607	40	42	45	4.7	1.7
60608	50	54	45	5.7	2.2
60610	65	66.7	45	9.2	4.2
60611	65	76.1	45	10.3	5
60612	80	88.9	45	11.7	5.7
60613	100	108	45	14.3	6.8
60101	10	12	90	3.1	1.4
60102	12	15	90	3.8	1.8
60103	15	18	90	4.2	2.2
60104	20	22	90	4.7	2.6
60105	25	28	90	5.7	3.4
60106	32	35	90	6.5	3.9

<i>Art. no.</i>	<i>DN</i>	<i>d<sub>g</sub> mm</i>	<i>arc °</i>	<i>L cm</i>	<i>Z cm</i>
60107	40	42	90	7.6	4.6
60108	50	54	90	9.5	6
60110	65	66.7	90	14.1	9.1
60111	65	76.1	90	15.7	10.4
60112	80	88.9	90	18.5	12.5
60113	100	108	90	22.9	15.4