

Installation Steps

Photo 1:

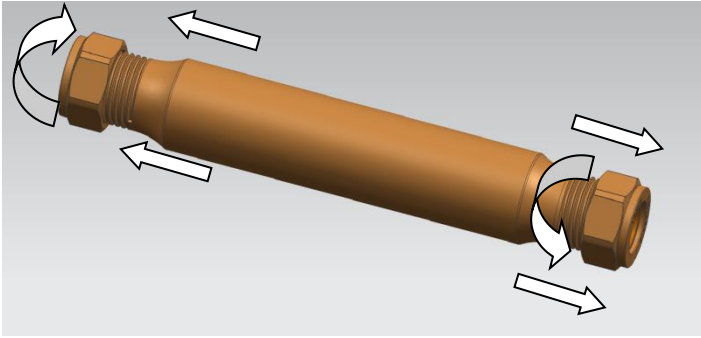

1. Split nuts, sleeve and body in direction of arrow (photo 1).

Photo 2:

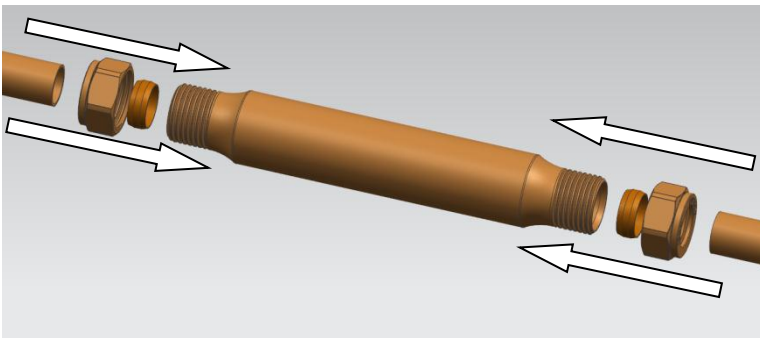

2. Assemble nuts, sleeve and body to copper tubes in direction of arrow (photo 2)

Photo 3:

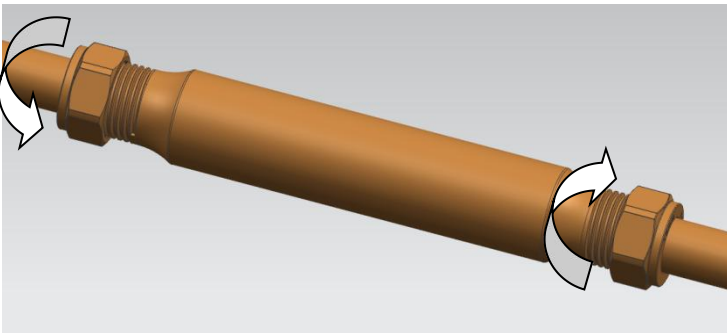

3. Use a wrench to clamp the hexagonal face of the nut, use a pipe wrench to clamp the outer face of the body, tighten the nut in the direction shown, and install the other end in the same way (photo 3)

4. Use a wrench to clamp the hexagonal face of the nut, use a pipe wrench to clamp the outer face of the body, tighten the nut in the direction shown, and install the other end in the same way (photo 3)

5. Nominal diameter of pipeline 15mm, installation reference torque, $60 \pm 1\text{Nm}$.