

stuart

PH ES Boostamatic Pressure Switch Pumps

The PH ES Boostamatic range of peripheral pressure switch pumps are designed to provide a pressurised water supply from a break tank in either positive or negative head applications.



Features

- Fully automatic control - positive and negative head
- No on-site setting/commissioning
- Built in 'no water' cut out
- No pulsing during operation
- Easy installation
- Reliable
- Quiet operation
- Compact size
- Manufactured using WRAS approved materials

Application

- This range has been designed to provide a pressurised water supply from a break tank and does not rely on gravity flow to activate
- All models are ideal for automated pressurisation of hot or cold water services in a single dwelling, or commercial premises

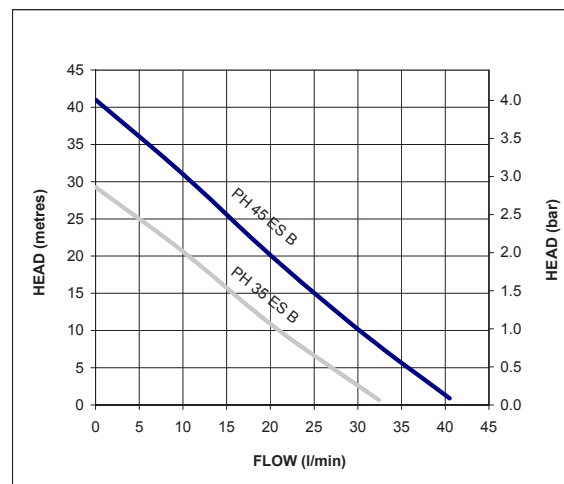

For further advice on selecting the correct pump call or e-mail info@stpumps.co.uk

pumpassist
HELPLINE +44 (0) 844 98 000 97

stuart

Pump Model		PH 35 ES B 46523	PH 45 ES B 46524
General	Guarantee	1 year	
Features	Pump type	Peripheral	
	Mechanical seal	Nitrile / Carbon / Ceramic	
	Anti-vibration feet	✓	✓
	Run on timer	3 sec	3 sec
	Dry run protection	✓	✓
Performance	Maximum head (closed valve)	30 metres	41 metres
	Performance @ 9 l/min	2.0 bar	3.2 bar
	Performance @ 18 l/min	1.2 bar	2.2 bar
	Maximum flow	33 l/min	42 l/min
	Minimum static inlet pressure	0.1 bar (1 metre)	
	Maximum static inlet pressure	1.3 bar (13 metres)	
	Maximum static outlet pressure	1.3 bar (13 metres)	
	Maximum working pressure*	600 kPa (6 bar)	
	Maximum ambient air temperature	40 °C	
	Min / Max water temperature**	Min 4 °C / Max 65 °C	
	Maximum suction lift***	4.6 metres	
Pressure vessel air pre-charge	0.9 bar (13 psi)		
Connections	Pump connections	G 1 female	
Motor	Type	Induction, auto-reset thermal trip	
	Duty rating	Continuous (S1) @ 2.5 l/min and above	
Electrical	Power supply / phase / frequency	230 V a.c. / 1 / 50 Hz	
	Current (full load)	1.6 Amps	2.4 Amps
	Power consumption	380 Watts	540 Watts
	Fuse rating	5 Amps	
	Power cable (pre-wired)	1.5 metres	
Physical	Enclosure protection	IPX4	
	Length	241 mm	270 mm
	Width	130 mm	
	Height (excluding hoses)	292 mm	
	Weight (including fittings)	6.0 Kg	7.5 Kg

* The maximum pressure that can be applied to the pump under any installation conditions.

** A stored water temperature of 60 °C is considered sufficient to meet all normal requirements and will minimise deposition of scale in hard water areas.

*** With footvalve fitted

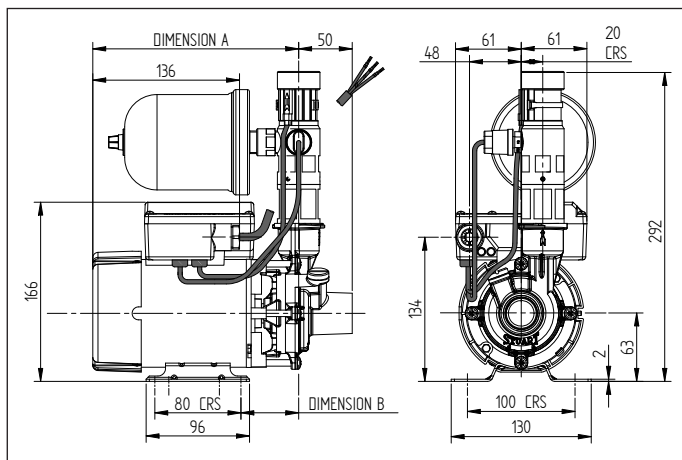

Pump Description	Dim. 'A'	Dim. 'B'
PH 35 ES B	191 mm	54 mm
PH 45 ES B	220 mm	54 mm

Stuart Turner Limited reserves the right to amend specifications without notice.