

INSTRUCTION MANUAL

Plain Mirror

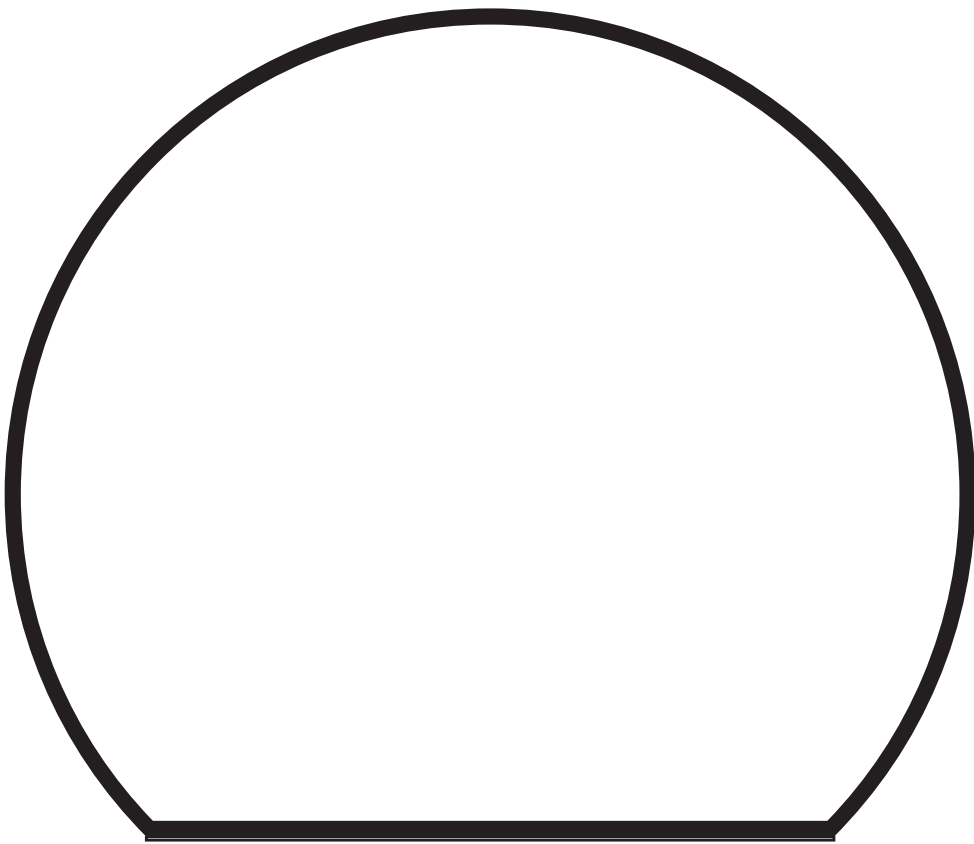

SKU:SHELFMIRCHR
SHELFMIRBB/SHELFMIRBLK

Hanging the mirror

Installation Tools

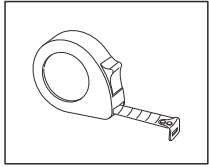

Measuring tape

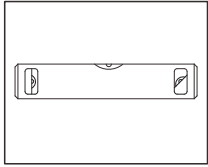

Spirit level

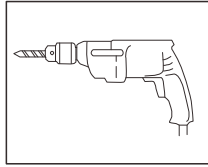

Drill

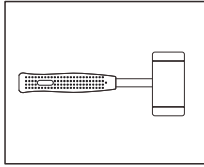

Hammer

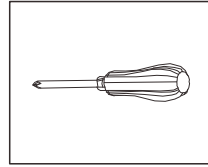

Screwdriver

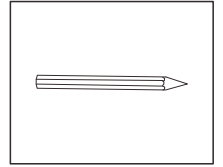

Pencil

Installation Steps

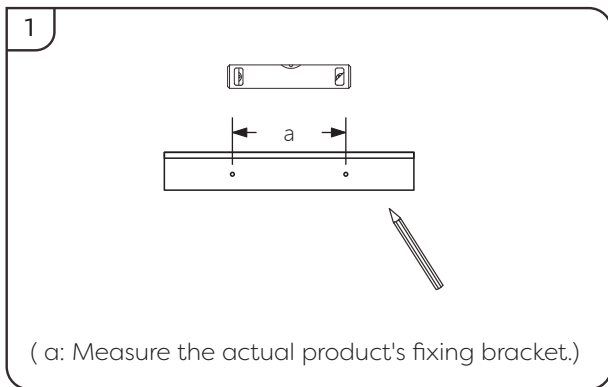

(a: Measure the actual product's fixing bracket.)

Make sure the wall is solid and suitable for safely supporting the overall weight of the mirror once installed.

Use a pencil to measure and mark the positions of the mirror nails, securing screws, and Rawl plugs. At the same time, use a spirit level to ensure the bracket is perfectly level.

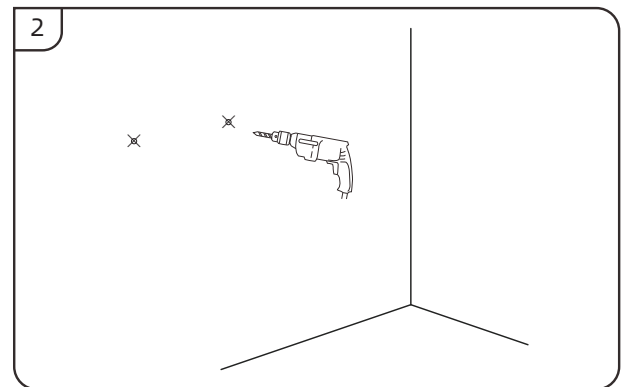

Select a $\phi 6$ drill bit and drill holes in the marked area to a depth of 40mm. (If the wall is tile, use a special ceramic drill).

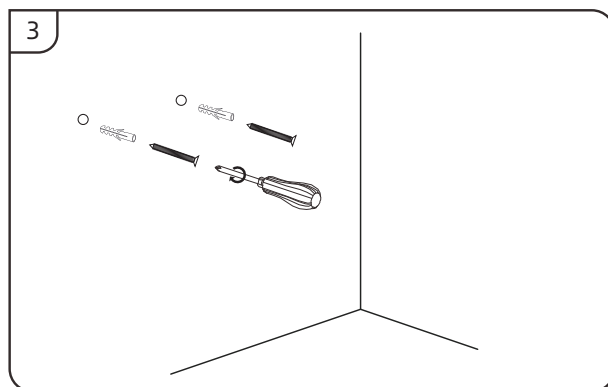

Insert Rawl plugs into drilled holes, and then screw the hook into the hole.

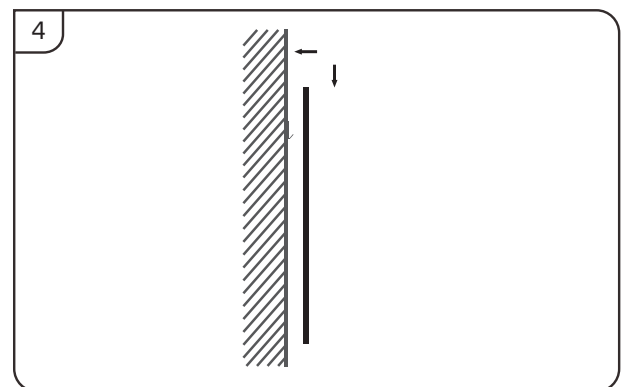

Hang the product on the wall hook.

Hanging the rack

Installation Steps

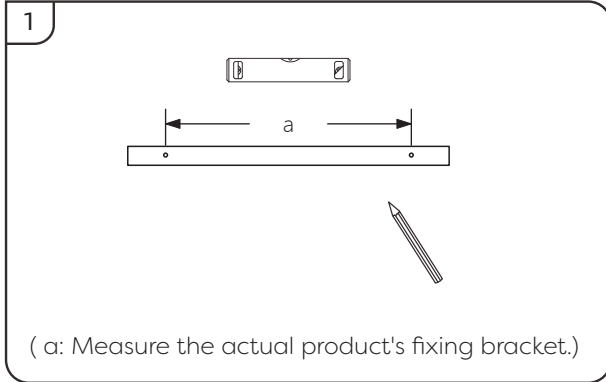

Measure and mark with a pencil, the position of the fixing bracket, securing screws & plugs while checking with a spirit level that the bracket is perfectly level.

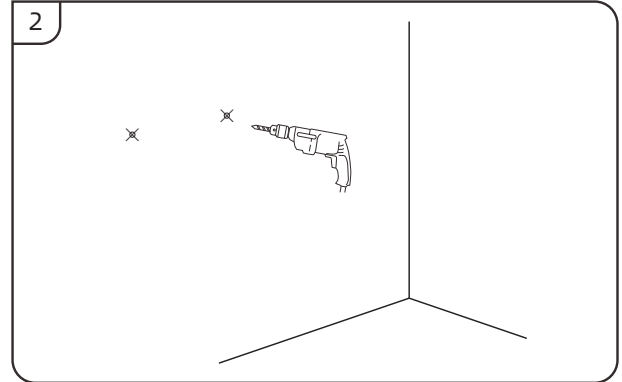

Select a $\phi 6$ drill bit and drill holes in the marked area to a depth of 40mm. (If the wall is tile, use a special ceramic drill).

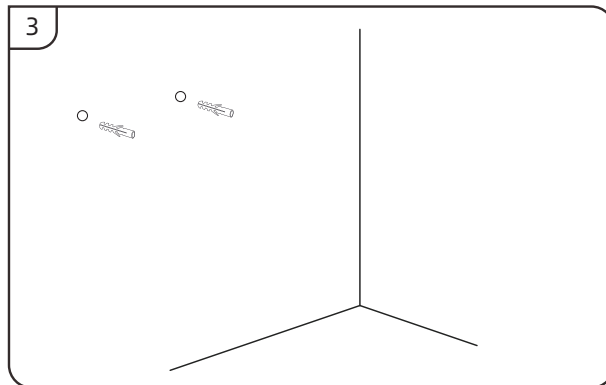

Insert Rawl plugs into drilled holes.

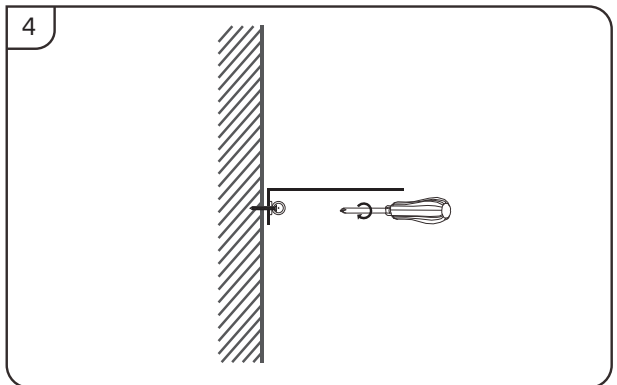

Screws are secured to the base by decorative silk caps and storage shelves. Put on a decorative hat.

Recycling and disposal

Please recycle the packaging in accordance with your local government regulations on waste handling, and follow the same advice at the end of the products life.