



Zip Tudor



Point of use water heaters.

Model number:

T4UB5, T4OB5 T4OB10, T4UB10



Table of contents

Safety information	3
WARNINGS 	3
CAUTIONS 	5
General product description	6
Approvals	7
Technical data	8
Dimensions	9
Spare parts	10
Pack contents and accessories	11
Installation	12
Requirements	12
Wall mounting	12
Over-basin installation	13
Under-basin installation	13
Electrical installation	14
Cable installation/replacement	14
Safety cut out	14
Commissioning & operation	15
Maintenance	16
Fault finding	17
End of life disposal	18
Warranty	19
Contact details	20

- Please read these instructions carefully before commencing installation of the point-of-use water heater.
- Please leave these instructions with the end user after installation.
- To ensure you have a copy of the latest instructions visit www.zipwater.co.uk.

SAFETY INFORMATION

IMPORTANT:

PLEASE READ THESE INSTRUCTIONS CAREFULLY. NOTE THE SAFE OPERATIONAL REQUIREMENTS, WARNINGS AND CAUTIONS. USE THIS PRODUCT CORRECTLY AND WITH CARE FOR THE PURPOSE FOR WHICH IT IS INTENDED. FAILURE TO DO SO MAY CAUSE DAMAGE AND/OR PERSONAL INJURY, AND WILL INVALIDATE THE WARRANTY. RETAIN THESE INSTRUCTIONS FOR FUTURE USE.

WARNING:

Indicates a potentially hazardous situation, which, if not avoided, could result in death and/or serious injury and/or property damage.

CAUTION:

Indicates a potentially hazardous situation, which, if not avoided, may result in property damage.

Safety Information

WARNINGS

- **Installation, commissioning and maintenance of this appliance must only be carried out by a competent installer who will then be responsible for adhering to all relevant standards and regulations.**
- **The appliance must be disconnected from mains power supply before carrying out any work involving live circuits.**
- The appliance must be permanently connected to the supply through an isolating switch with a contact separation of at least 3mm in all poles and be protected by a suitably rated RCD.
- To protect the appliance, an MCB (miniature circuit breaker) or cartridge fuse must be fitted with a rating suitable for the nominal current of the appliance.

SAFETY INFORMATION

- The cross sectional area of the connection cable must be appropriate for the power rating and location of the appliance. See Technical data, page 8.
- The connecting cable must be adequately secured.
-  This appliance must be earthed at all times.
- Check that the power supply is switched off prior to electrical connection.
- The appliance, its wiring and piping must not be modified in any way.
- In case of malfunction isolate the power supply immediately. In case of leaks also isolate the water supply. Repairs must only be carried out by a competent person.
- Temperatures in excess of approximately 43°C are perceived as hot, especially by children, and may cause a feeling of burning.
- This appliance can be used by children aged from 8 years and above and persons with reduced physical, sensory or mental capabilities or lack of experience and knowledge if they have been given supervision or instruction concerning use of the appliance in a safe way and understand the hazards involved. Children shall not play with the appliance.
- Cleaning and user maintenance shall not be made by children without supervision.
- Under no circumstances is the water heater to be used if suspected of being frozen, (see page 15).

CAUTIONS

- The water vessel is intended for an open outlet and should never be subject to greater than atmospheric pressure.
- The inlet control valve should not be subject to pressure exceeding 0.35 MPa (3.5bar).
- The appliance must only be used when correctly installed and in perfect working order.
- The appliance must be installed in a frost-free room and must never be exposed to frost.
- The appliance must be completely filled with water before the electrical supply is switched on.
- THE HOT WATER SHOULD BE DELIVERED FROM THE OPEN OUTLET SPOUT SUPPLIED OR A ZIP APPROVED OPEN OUTLET TAP FITTING THAT REMAINS PERMANENTLY OPEN TO ALLOW FOR EXPANSION THAT OCCURS DURING THE HEATING CYCLE. UNDER NO CIRCUMSTANCES SHOULD THE SPOUT OR OUTLET BE CONNECTED TO A TAP WHICH IS CAPABLE OF BEING CLOSED.
- The Zip Tudor models are intended for connection to a mains wholesome supply only. In any other case please contact Zip on 0345 6 005 005 for advice.
- **Zip Water cannot be held liable for any damages caused by failure to observe these instructions.**

General product description

- The Zip Tudor models are SINGLE point-of-use open outlet water heaters. Being displacement type water heaters the hot water flow is controlled by the rate at which cold water enters the vessel. They can be connected either to the cold water main or fed from an overhead cold water cistern (minimum head 3m).
- Being fully automatic the Zip Tudor may be left switched on under the control of the thermostat, however **WARNING**  This means that the unit remains potentially 'LIVE' when the selector is set to '0'. The unit can only be switched off (isolated) by operating the double pole isolating switch to isolate the heater unit from the power supply.
- The stored hot water is delivered from an open outlet spout (supplied with over-basin models) or a Zip approved open outlet vented tap. This type of fitting is permanently open to the atmosphere which allows the expansion of water, (that occurs during the heating cycle), to be safely discharged.
- During the heating cycle, drips will form and fall from the delivery spout or tap and these will cease when the cycle has been completed and the stored water temperature has reached the level set by the user. The higher the temperature selected the greater the rate of expansion. Over-tightening of the inlet water control valve or tap will not prevent the drips that occur, but may cause damage to the valve or tap.

Temperature control



- The temperature control enables an operating temperature up to 75°C to be selected. To protect the water heater against frost the temperature control setting may be positioned at  when a stored water temperature of 9°C will be maintained.

Note this protection does not extend to connecting pipework or fittings.

The economy setting **e** will maintain the most economical stored water temperature at approximately 41°C for models T4OB5, T4UB5 or 35°C for models T4OB10, T4UB10.

Lime-scale formation and heat loss are minimised at the economy **e** setting, however the operating temperature may be increased as required where higher temperature hot water or a greater volume of mixed water is required. Setting **III** = 75°C.

Neon lamp

- The Neon lamp will illuminate while the elements are in operation but will extinguish when the chosen temperature has been reached. **CAUTION**  The unit will remain 'LIVE' when the neon lamp does not glow.
- **WARNING**  Once installed DO NOT remove the cover under any circumstances without first isolating the electrical supply to the heater.

Approvals

The Zip Tudor models are approved to the LVD & EMC directives as well as UK product safety regulations, and are CE and UKCA compliant.

The Zip Tudor models have been examined, tested and found when correctly fitted to comply with the requirements of the United Kingdom Water Regulations / Byelaws (Scotland).

Technical data

Zip Tudor					
MODEL		T4OB5	T4UB5	T4OB10	T4UB10
Installation		Over basin	Under basin	Over basin	Under basin
Declared load profile		XXS			
Energy efficiency class ⁽¹⁾		A			
Energy efficiency (wh) ⁽¹⁾	%	35.2	35.0	35.3	35.1
Annual electricity consumption ⁽¹⁾	kWh	525	527	523	525
Thermostat temperature setting		e ⁽²⁾			
Specific precautions		See installation and operating instructions			
“Smart” value		0			
Rated volume	l	5.5	5.7	9.8	9.9
Weight empty / full	kg	3.5 / 8.5		4.0 / 14.0	
Power rating	W	2,000			
Nominal supply voltage	V AC	230			
Protection class		IP24			
Heat up time (10°C to 65°C)	mins	10		20	
Packing dimensions	mm	270 x 315 x 455		325 x 370 x 520	
Water supply pressure	MPa	0.03 - 0.35 ⁽³⁾			
Water connections		1/2" BSP			

(1) EU Regulation 812/2013; EN 50440

(2) Temperature control ‘e’ setting corresponds to approx 41°C for models T4OB5, T4UB5 or 35 °C for models T4OB10, T4UB10

(3) For higher supply pressures a Zip AQ3 pressure reducing valve is recommended.

Dimensions

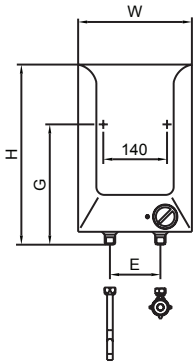

T4OB5

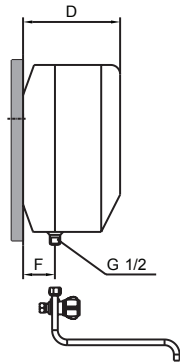

T4OB10

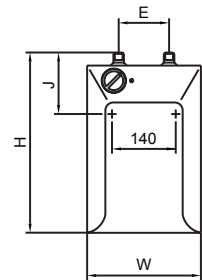
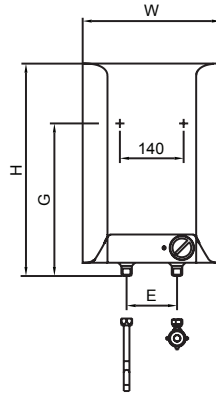

T4UB5

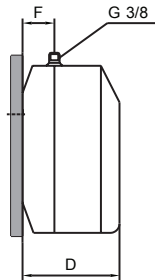

T4UB10

Dimension table

Model	W	D	H	E	F	G	J
T4OB10	310	265	471	100	70	371	n/a
T4UB10	310	265	471	100	70	n/a	196
T4OB5	255	215	390	100	70	264	n/a
T4UB5	255	215	390	100	70	n/a	138

All dimensions in mm

Note

Over-basin and under-basin models are NOT interchangeable. For under-basin applications use models designated 'UB' and use only Zip approved vented tap accessories.

Spare parts

Item	Description	Part no.
1	Heating element	95110
2	Element 'O' ring	CT0116/3
3	Safety cut-out	95211
4	Neon light indicator	CT0129/4
5	Element retaining nut	CT0115/4
6	Standard outlet spout	CT0137
6	Short outlet spout	CT0137/S
7	Thermostat	CT0119/4

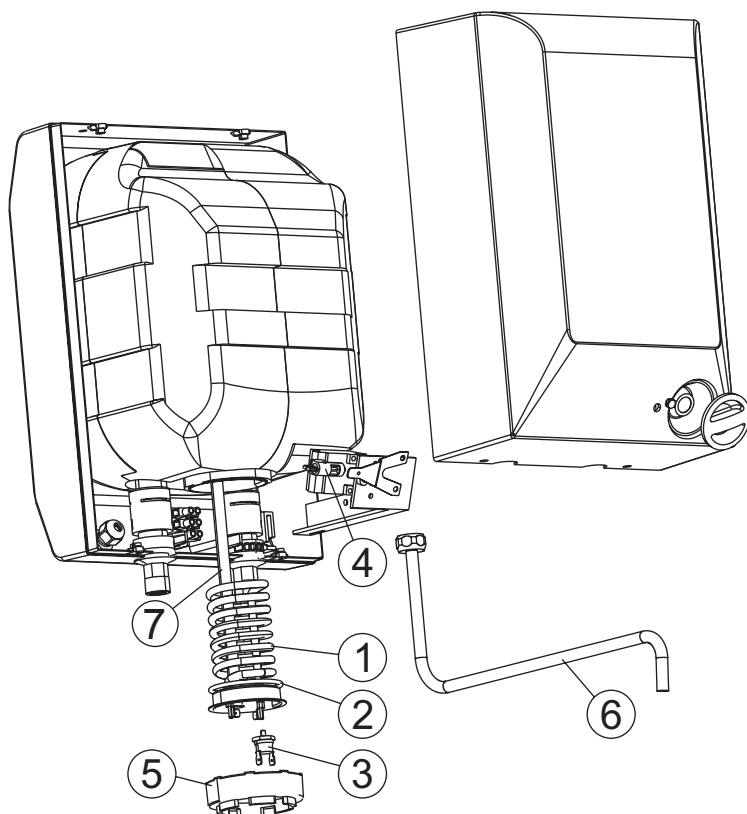

Pack contents

Please check that the items listed below have been supplied in the product pack.

Item	Qty
Wall Bracket	1
Control Valve	1*
Outlet spout	1*

*(except UB models)

Accessories

Only Zip approved open outlet accessories should be used, the following are available.

Over-basin

TS1 Telescopic Spout 350-600mm.

Under-basin

UB1 Monobloc Mixer Tap.

UB6 Single Lever Basin Tap.

UB7 Single Lever Sink Tap.

Call Zip on 0345 6 005 005.

Installation

Requirements

- Before starting installation the **WARNINGS** ⚠ page 3 and **CAUTIONS** ⚠ page 5 should be read and fully understood.
- It is recommended that the piping and water connection is carried out by a qualified plumber.
- Thoroughly flush the water supply pipes before installation to remove any water borne debris.
- The electrical installation including earthing and cross bonding should comply with current IEE regulations and any Local Authority requirements.
- Zip Tudor water heaters must be installed according to the specification on the rating plate and the technical specifications (see page 8).
- Take care to protect the wiring from damage during installation and ensure that any uninsulated wiring is not directly accessible after installation.
- For maintenance work an isolating valve should be installed in the water supply line to the heater.
- A minimum clearance of 270mm is required underneath the over-basin heater units and above the under-basin units to allow for the removal of the element plate assembly and for servicing purposes.
- When locating the heater, consideration should be given to the safe and visible disposal of any water resulting from leaks and seepage.

Wall Mounting

- The unit will be supported by being hung on a bracket fixed to a support wall, using the fixings provided, as shown in Fig.1
- Therefore it is important to ensure that the wall is strong and solid enough to fully support the unit when the tank is full.
- It is important to ensure when drilling the wall, that the selected position avoids any pipe work or electrical cabling. To mount the heater, the bracket 'hooks' locate into the slots provided in the back of the unit, allowing the unit to hang flat against the wall.

Fig. 1

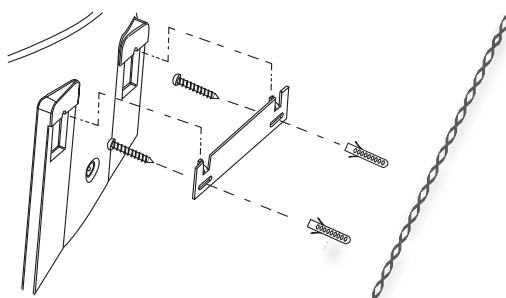

Note It is not necessary to remove the casing to mount the water heater on the wall bracket.

Installation

Over-basin Installation

- The inlet control valve supplied incorporates compression fittings suitable for fitting between 15mm copper piping (water supply) and the inlet connection (coloured blue) situated on the water heater.
- Fit the control valve to the cold water supply ensuring that the water will flow in the direction of the arrow indicated on the side of the control valve (Fig.2).
- Do not over tighten the compression joints but ensure that they are leak free.

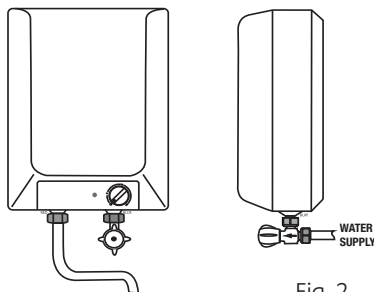

Fig. 2

Under-basin Installation

- Connect the hose from (A) on the tap body to the mains cold water supply.
- Connect the hose from (B) on the tap body to the cold water supply to the heater.
- Connect the hose from (C) on the tap body to the hot water output on the heater.
- Fill the heater tank before turning the power on.
- Turn on the water supply and check for leaks.
- Open both hot & cold taps until water freely flows from the tap spout.
- Turn on the heater and allow it to heat up.

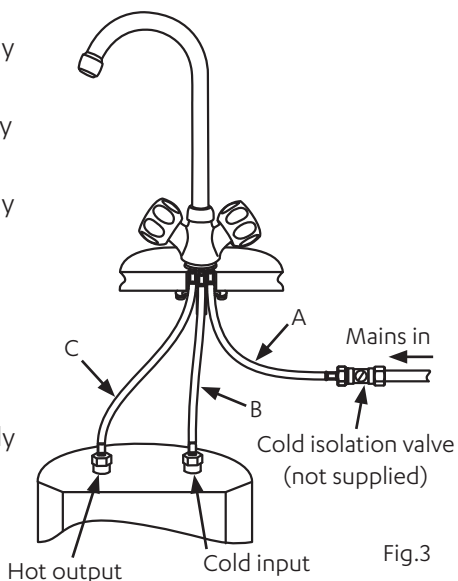

Fig.3

Note

When installing under-basin models it is recommended that fibre washers are used on both inlet and outlet connections to ensure a watertight seal.

⚠ WARNING Switch off the mains electrical supply before carrying out any work involving a live circuit. 230V AC supply only, this appliance must be earthed. Before starting installation the **WARNINGS** ⚠ page 3, and **CAUTIONS** ⚠ page 5, should be read and fully understood. It is recommended that the electrical installation is carried out by a qualified electrician.

Pre-wired cable

The Tudor models all come pre-wired with a 1 metre length of cable. If in the lifetime of the unit the cable is damaged or a greater length of cable is required then to replace the supply cable, refer to the following 'Cable installation/replacement' instructions below.

Cable installation / replacement

- First remove the temperature adjustment selector switch and release the screw located beneath.
- Unscrew the four cover screws, two on the top and two on the bottom of the unit, this will then allow the outer cover to be removed.
- The supply cable conductors must have a nominal cross section of not less than 1.5mm².
- The supply cable enters the casing through a cable clamp located in the rear casing cover.
- Make the connections in the terminal block provided as indicated in (Fig.4), then after ensuring that the cable is firmly clamped, replace the front casing, cover and selector switch.

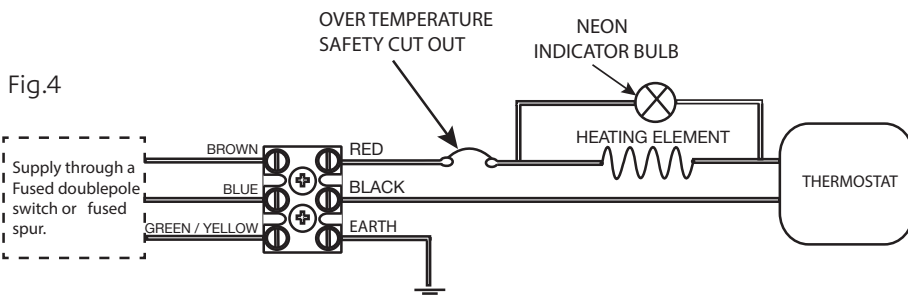

Safety Cut Out

- In the event of a malfunction that leads to an over temperature event the safety cut out will automatically cut off the electrical supply to the element (see Fig.4).
- The automatically resettable cut out can be reset by simply switching off the electricity supply, emptying the tank and refilling with cold water (open the inlet control valve or tap until cold water runs continuously) then waiting for the cut out to cool down and reset itself.



Do not switch on the heater until it is filled with water

- Open the inlet control valve or tap to allow the tank to fill with water, the tank will be full when water begins to run continuously from the spout or tap.
- Close the inlet control valve or tap and switch on the electrical supply, adjusting the temperature control to the required level.
- The contents of the water vessel will be heated to the selected temperature.
- During the heating cycle expansion will take place and water will drip from the spout or tap. This will cease when the operating temperature has been reached, (approx 10 mins. for the 5L models, approx. 20 mins. for the 10 litre models).
- Therefore always ensure that the spout outlet is positioned over the basin.
- Hot water is drawn off by opening the inlet control valve or tap, this allows cold water to enter the storage vessel as the heated water is displaced and is flowing out.



Safety Warning

- Under no circumstances is the water heater to be used if suspected of being frozen.
- If water ceases to flow, switch off the electrical supply immediately at the isolating switch.
- It is then recommended that a qualified Plumber/Electrician checks the unit.
- Any water can be drained via the cold inlet connection whilst in the original location.
- To remove the outer case, prise off the temperature selector switch and release the screw located beneath it.
- Remove the four front cover securing screws at the top and bottom of the unit, then the outer case can be lifted off.

Maintenance and cleaning

General cleaning

Plastic surfaces and fittings should only be wiped with a damp cloth. Do not use abrasive or chlorine-based cleaning agents or solvents.

The outlet fittings should be unscrewed and cleaned at regular intervals.

The electrical and plumbing components should be inspected at least every 3 years by a competent person familiar with point of use water heaters, to ensure proper functioning and operational safety. Water quality should be considered when determining the frequency of inspection.

Note Maintenance work must only be carried out by a competent person familiar with point of use water heaters.

Repairs

All service work should be performed by an authorized Zip service engineer – for details of the full range of services available call Zip Service on 0345 6 005 005.

Fault finding

Fault	Possible cause	Solution
No water	Mains water not turned on	Check supply and turn on
No hot water	Over temperature cut out has operated	Refer to instructions on page 14
	Faulty thermostat	Replace thermostat
	Faulty element	Replace element
Water is too hot	Thermostat is set too high	Reset thermostat
	Faulty thermostat	Replace thermostat

Please contact Zip for advice on 0345 6 005 005.

End of life disposal



The use of this crossed out wheeled bin logo indicates that this product needs to be disposed of separately to any other household waste.

Within each of the European Union member countries, provisions have been made for the collection and recycling of unwanted electrical and electronic equipment.

In order to preserve our environment we ask that you dispose of this product correctly. Please contact Zip for advice on 0345 6 005 005.

Warranty

Our goods and services are supplied in accordance with our standard terms and conditions. This policy sets out the warranty period and exclusions which apply to the Tudor range. This policy is subject to our standard terms and conditions and should be read in conjunction with those terms, particularly clause 5 of the terms and conditions.

Warranty

The warranty period for the Tudor range is 1 year.

Subject to the exclusions set out below and in clause 5 of the terms and conditions, faulty parts and products will be replaced or repaired free of charge by Zip, its distributor or service provider, where such faults arise during the applicable warranty period.

Exclusions

1. This policy only applies where:

(i) The product is installed and used strictly in accordance with the terms and conditions and the instructions supplied with the product; and

(ii) The failure is not due to accident, misuse, abuse, unsuitable water conditions (including contaminants or inappropriate water pressure), or to any alteration, modification or repair by any party not expressly nominated by Zip.

2. This warranty does not cover damage resulting from non-operation of the product or consequential damage to any other goods, furnishings or property.

3. This warranty does not apply to any consumables.

4. Zip residential (for home) products are designed specifically for use in a domestic, residential location. Inappropriate installations, such as in a commercial environment (including residential care homes or medical facilities), will invalidate the warranty.

Service Work

Ad hoc repairs by Zip or its approved service providers are covered under Warranty for 30 days in relation to the original fault only.

If you are a HydroCare Service Plan subscriber please refer to the HydroCare terms and conditions for information on applicable warranties and warranty periods for HydroCare services.

Registering your purchase

Registering your zip installation on the zip website may help to establish date of installation should it become necessary to service the appliance under terms of the zip warranty. To register your installation visit www.zipwater.co.uk/product-registration.



Zip Water

Trafalgar House, Rash's Green, Dereham, Norfolk, NR19 1JG.

0345 6 005 005 sales@zipindustries.co.uk

www.zipwater.co.uk